

# Luxury Mesa Traveler United States

Modèle standard

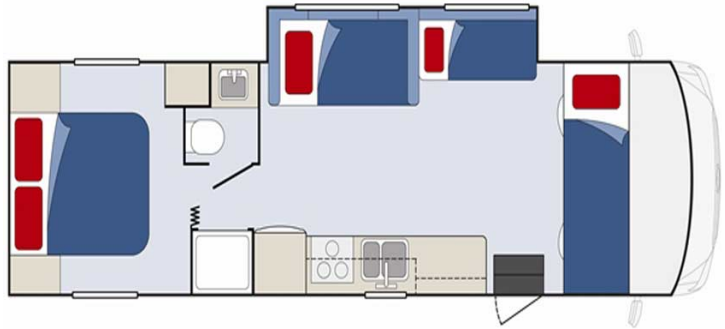
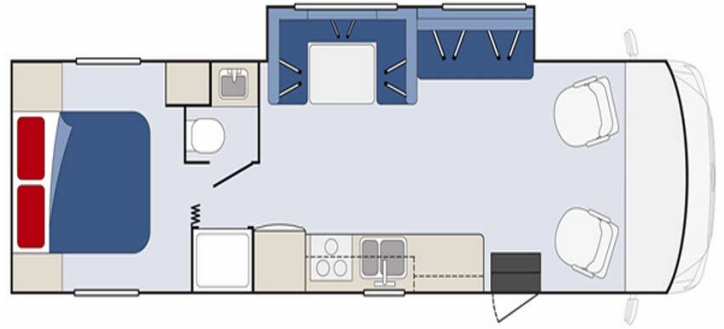

Description

This 2016 luxury model has everything you need: panoramic windshield, back-up camera, fully equipped kitchen, separate bedroom with king bed, all for comfortable travel for up to 5 passengers.

Characteristics

**Mesa Traveler-Classe A " Panoramic vision"** Sleeps : 5 (adults), **Please note that children under the age of 8 years cannot travel in this vehicle!** Models guaranteed to have maximum of 12 months usage, 6.8 L petrol engine, Approx: 30-35L/100 km (7mpg), Ford chassis, Automatic transmission, Power steering, Driver's cabin open to living area  
Air conditioning and heating like in a car, Air conditioning when parked via external power outlet (hook up) 110V or a generator, Heating when parked runs on propane gas but requires an via external power outlet (hook up) 110V or a generator, Radio, TV LCD, DVD player

**Generator 295kW.** Enables the functioning of the wall plugs, microwave, air conditioning and heating when the vehicle is not running or plugged in to an external power outlet (hook up).

**Gas (propane).** Enables the functioning of the fridge, water heater and heating when the vehicle is not running or plugged in to an external power outlet (hook up).

**External power "hook up" 110V**

**Auxiliary battery.** Enables the functioning of the lights. This battery remains charged for 12 hours and recharges when the vehicle is driving or plugged in to an external power outlet (110 V hook up). When booking camp sites, choose hook ups of 20 or 30 Amps.

**Cigarette lighter.** Charges small electrical appliances such as mobile phones and cameras with an adaptor.

**Complimentary equipment :** Slide out, Rear vision/reversing camera, Fire extinguisher

**Optional equipment :** Premium Kit per person including linen and towels, Camping chairs, Camping table, GPS, WC/toilet chemicals

**Dimensions :** Length: 9.4 m (30'10"), Width: 2.6 m (8'6"), Height: 3.7 m (12'2"), Interior height: 2.0 m (6'6"), Petrol/Gas tank: 283 L (74.8 US gal), Fresh water tank: 242 L (63.9 US gal), Grey water tank: 155 L (40.9 US gal)

**Beds :** Rear bedroom bed: 190 cm x 150 cm (75" x 59"), Over cab bed: 200 cm x 80 cm (79" x 32"), Dinette bed: 210 cm x 110 cm (83" x 43"), Sofa bed: 150 cm x 100 cm (59" x 39")

**Kitchen & Bathroom :** Fridge: 170 L (44.9 US gal), Oven, Microwave, 3 burner stove, Dishes and kitchen ware, Hot and cold water, Shower, Toilet, Hot and cold water