

# Profile Lakka Medium Finland

Modèle deluxe

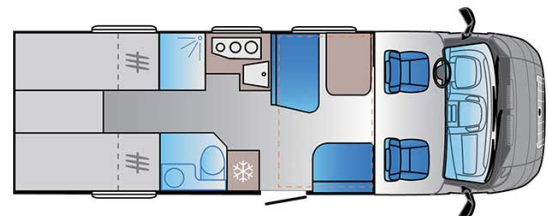
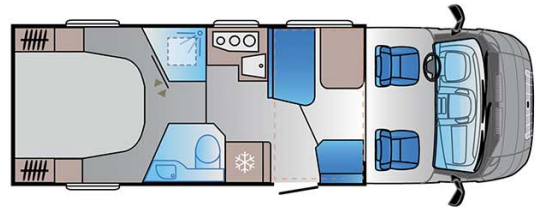
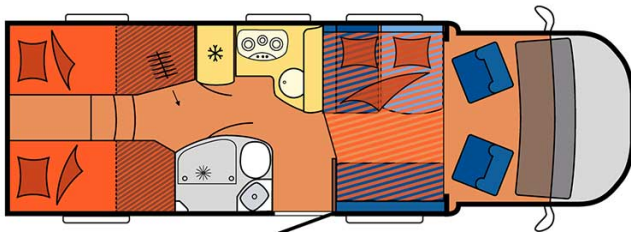
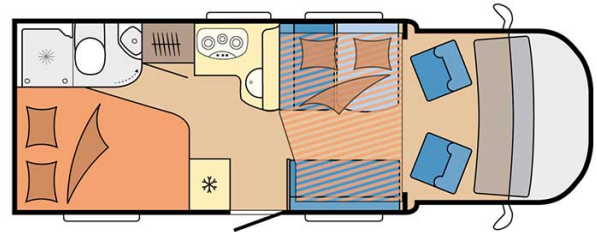

Description	<p>updated 12/2023</p> <p>A very versatile vehicle that will allow a family of 4 to travel any road comfortably. Lots of storage space.</p> <p>The plans, dimensions and layouts here are indicative and may vary without notice.</p> <p><a href="#">VIDEO - Motorhome orientation.</a></p>
Characteristics	<p><b>Lakka Medium</b></p> <p>Sleeps : 4</p> <p>Turbo Diesel Engine</p> <p>Fiat/Citroen chassis</p> <p>Manual or automatic transmission</p> <p>Airbags</p> <p>Navigation system</p> <p><a href="#">? Virtual visit of the Lakka Medium model here.</a></p>
Fuel	<p>Diesel</p> <p>Average consumption: 10-12 L/100km</p>

Dimensions	Length: 5.90 to 7.60 m Width: 2.30 to 2.40 m Height: 2.50 to 3.20 m
Passengers	4 sleeps
Reserve	Fuel tank: 90L (23.8 US gal) Fresh water tank: 100L (26.4 US gal) Waste water tank: 96L (25.4 US gal)
Beds	Middle double bed: 200 x 115-135 cm Rear double bed: 200-190 x 140-160 cm or single beds: 2 x 90 x 200
Kitchen	Sink (hot and cold water) Cooker 3 stoves Fridge min. 80L Dishes and cutlery
Shower/Toilet	Shower Toilet Hot and cold water
Heating/Air Conditioning	Heating and air conditioning like in a car Heating while parked
Energy	<b>Gas.</b> Allows for use of the refrigerator, water heater, and heater, while not connected to an electrical hook-up. <b>Electrical Connection 230V (Hook-up)</b> <b>Auxiliary Battery.</b> Batteries will last around 12 hours depending on use, and are recharged when driving the vehicle, or hooked up the 230V connection. <b>12V outlet:</b> Remember to bring your adaptors for charging your personal electronics such as cameras and phones.
Audio & Connexions	Radio AM/FM Bluetooth
Complementary Equipment	Leveling blocks Fly screens Sun curtains Tire repair kit Fire extinguisher First aid kit Ceinture de sécurité à trois points Electric cable Adapter Storage compartment: 90 x 25 cm / 75 x 29 cm