

Van Wombat Hitop Ultra Australia

Modèle standard

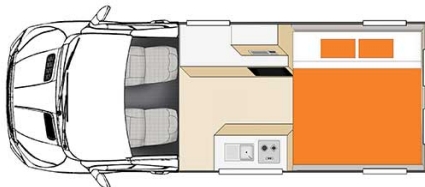
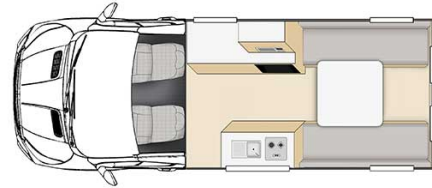

Description	<p>Outfitted with a quality fridge, gas stove and sink. Enjoy each night resting in the spacious double bed in the main cabin.</p> <p>The plans, dimensions and layouts here are indicative and may vary without notice.</p>
Characteristics	<p>Wombat Ultra Sleeps: 2 Please note that children under the age of 6 months cannot travel in this vehicle. Engine Diesel Automatic transmission Power steering Airbags and ABS Driver's cabin open to main cabin Rear vision camera Model guaranteed maximum 3 years old</p>
Fuel	<p>Diesel Average consumption : 12L/100 km</p>

Dimensions	Length: 5.50 m (18'1") Width: 2.06 m (6'8") Height: 3.10 m (10'2") Interior height: 1.95 m (6'4')
Passengers	2 seats and 2 sleeps
Reserve	Fuel tank: 80 L (17.6 US gal) Fresh water tank: 110L (24.2 US gal) Grey water tank: 110L (24.2 US gal) Gas bottle: 1 x 9kg
Beds	Double bed: 188 x 162 cm
Kitchen	Sink (hot and cold water) 2 burner Fridge 80L + freezer Microwave (240V) Dishes and cutlery
Shower/Toilet	No shower or toilet
Heating/Air Conditionning	Heating/Air conditioning driving: like in a car Heating/Air conditioning stopped: by 240V electrical connexion
Energy	Electrical Connection 240V (Hook-up) Auxiliary battery. Allows to operate the lights. It has an autonomy of about 12 hours and is recharged while driving or being connected to 240V. Gas. 1 x 9kg Cigar lighter. Remember to take adapters to recharge small electrical appliances such as telephones or cameras.
Audio & Connexions	Radio Media player depending on the models
Complementary Equipment	Fire extinguisher Fly screens on some windows