

# Profile Kings B 20-22 United States

Modèle deluxe

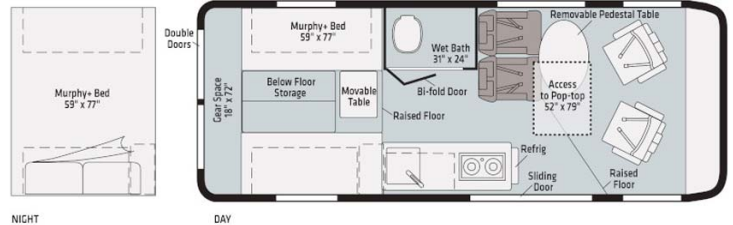

Ultrafabrics  
UF2 Premium  
Leatherette

Vinyl

## 2022 SOLIS 59PX



Description	This vehicle max. 1 year old is ideal for <b>couples or families of 2 adults and 2 children</b> , the Kings B20-22 allows the family to travel in comfort and tranquillity with its high quality equipment and interior and <b>high fuel efficiency</b> .
Characteristics	<b>Kings B 20-22</b> Sleeps : up to 4 Max. 1 year old model Engine V6 Automatic transmission Cruise control Backup camera <a href="#">? Virtual visit of the Kings B20-22, 2023-2024 model here.</a>
Fuel	Average consumption: 17L/100km (14 mileaeg/mpg)
Dimensions	Length: 6.4 m (21') Width (without mirrors): 2.06 m (6'9") Height: 2.87 m (9'5") Interior height: 1.9 m (6'3")
Passengers	Sleeps 4 and 4 seatbelts - Forward facing seats and front swivel seats.

Reserve	Fuel tank: 91 L (24 US gal) Fresh water tank: 76 L (20 US gal) Grey water tank: 76 L (20 US gal)
Beds	Rear folding bed: 196 x 150 cm (77" x 59") Roof topbed: 200 x 132 cm (79" x 52")
Kitchen	Fridge with freezer Cooker 2 stoves
Shower/Toilet	Shower Toilet Sink Hot and cold water
Heating/Air Conditionning	Drivers Cabin A/C Main cabin A/C Heating
Energy	<b>On-Board Generator.</b> Allows for use of wall plugs, heating and air conditioning when vehicle is not connected to an electrical hook-up. <b>Propane Gas.</b> Allows for use of the refrigerator, water heater, and heater, while not connected to an electrical hook-up. <b>Electrical Connection 110V (Hook-up)</b> <b>Auxiliary Battery.</b> Allows for use of lights. Batteries will last around 12 hours depending on use, and are recharged when driving the vehicle, or hooked up the 110V connection. When booking a campsite, choose 30 amp (or 20 amp) connections. <b>Wall Sockets:</b> Only function when the vehicle is connected to 110V connection or while running the on-board generator. <b>12V outlet:</b> Remember to bring your adaptors for charging your personal electronics such as cameras and phones.
Audio & Connexions	Radio AM/FM USB connectivity
Complementary Equipment	Child seat tether anchor Hitch
Optional Equipment	Bike carrier